



**AGRICULTURE & GREEN SPACE**  
rotary toppers - flail mowers - solo-swing mowing discs



[www.perfectvanwamel.com](http://www.perfectvanwamel.com)

## Development of PERFECT machines

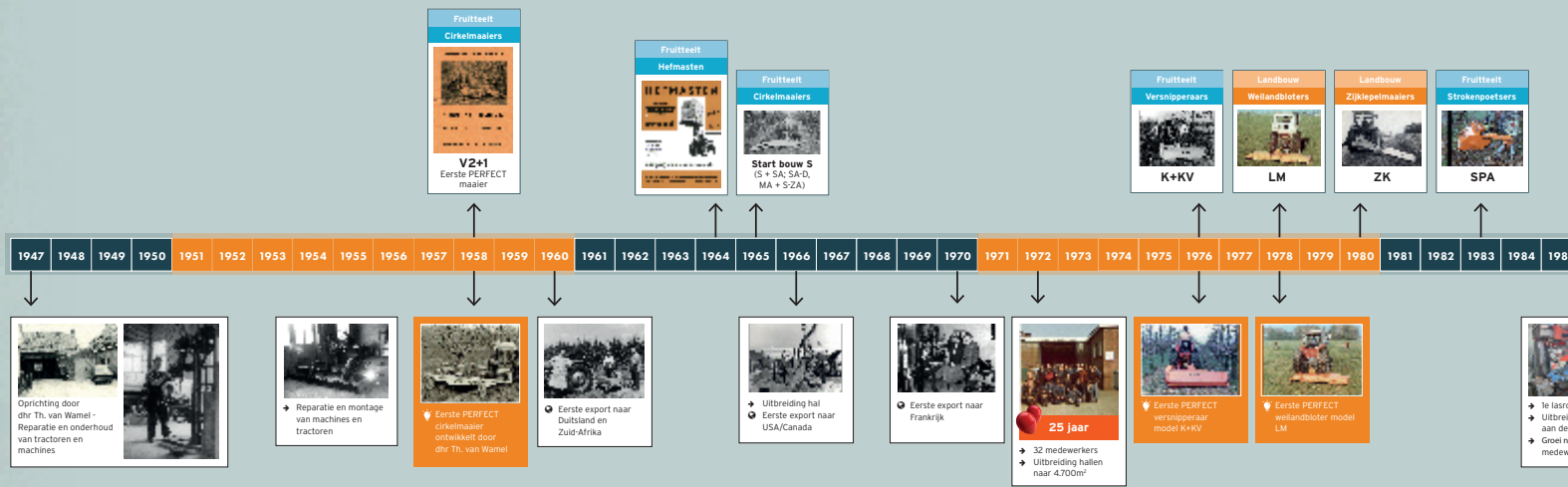

## Growth in organization & employees

### TIMELINE

## PERFECT development

PERFECT - Van Wamel has been a manufacturer of PERFECT flail mowers, rotary mowers for almost 80 years.

Our high-quality machines are designed and produced entirely in our factory in Beneden-Leeuwen. Whether you are a fruit grower, contractor, dairy farmer, landscaper or government agency, we will supply you with the appropriate machine.

PERFECT machines and Van Wamel bv are known for their excellent quality, reliability and service and are aimed at the professional user.

# DEVELOPMENT OF MACHINES 1947 - 2022

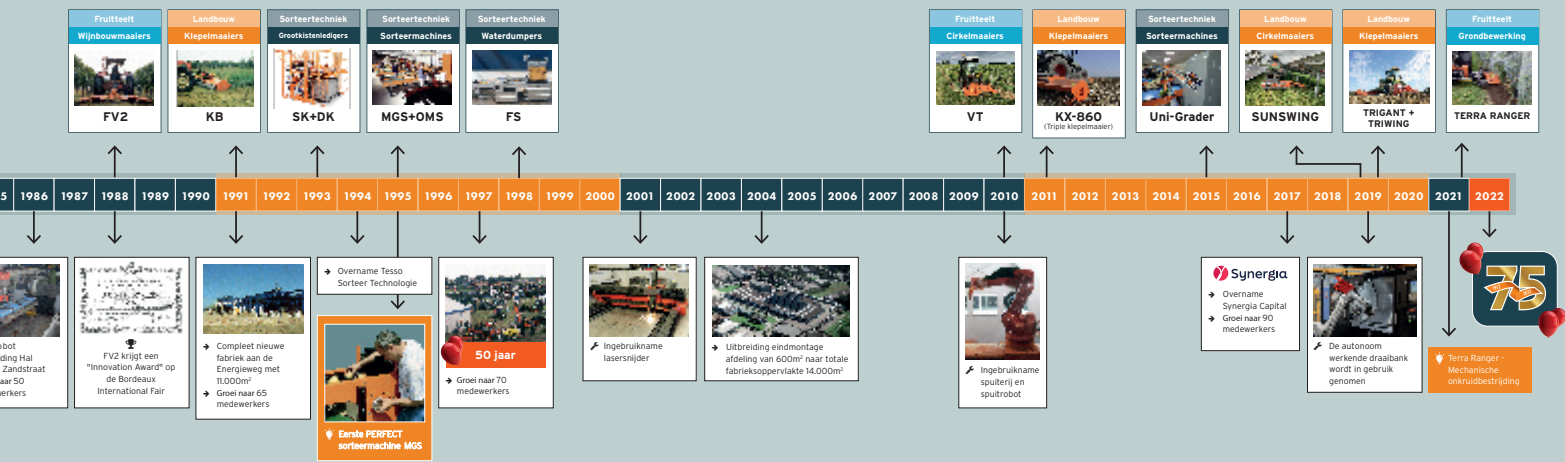



# PERFECT flail and rotary mowers

PERFECT machines have been designed and built in Beneden- Leeuwen completely under own management since 1947. The manufacturing process is characterized by using the very best materials/components and state-of-the-art production methods. Our team of 3D designers utilises the most advanced simulation techniques in order to guarantee optimal functionality and operation.

Externally purchased parts such as bearings, PTO shafts and gearboxes are only procured from suppliers that can meet the high quality standards that we demand

for the PERFECT line of machines.

All these factors contribute to the extremely high and consistent reliability for which PERFECT flail and rotary mowers are renowned all over the world.

In addition, in order to guarantee long-term operational dependability, and to keep break-downs and downtime to a minimum, PERFECT offers an excellent streamlined spare parts delivery service, maintains large stocks and provides highly effective technical support.

## TABLE OF CONTENTS



ROTARY MOWERS	5
SOLO-SWING MOWING DISCS	8
FLAIL MOWERS	11
➤ COMPACT FLAIL MOWERS	12
➤ STANDARD FLAIL MOWERS	14
➤ HEAVY DUTY FLAIL MOWERS	15
➤ MULTI MOWERS	16
➤ SIDE FLAIL MOWERS	17
➤ LARGE SURFACE FLAIL MOWERS	18
FLAILS	21
TECHNICAL INFORMATION	22

## ICONS



Standard 3-point rear, front mount option



Standard front-mount and rear-mount



Standard 3-point rear mount



Hydraulic driven



Standard mowing/topping



Heavier mowing



heavy-duty work



PTO 540 rpm.



PTO 1.000 rpm.



0,9 kg/2,4 lbs or Flex-flails



0,9 kg, 2,2 kg or Combi-flails

ROTARY MOWERS - TOPPERS

# PERFECT rotary mowers



**PERFECT rotary mowers owe their highly renowned cutting capacity and extremely long lifespan to the following features:**

- The V-belt drive, which prevents the gearbox and PTO shaft against overloading
- The long, profiled skids, which enable working speeds up to 6.5 mph/10 km/h (not for SUNSWING)
- For the heaviest jobs, a gearbox driven mower is available (LK Series)



Swing-away blades and/or support saucers



LB-series with hydraulic offset



LB-series front mount



➤ **SUNSWING**

Extremely robust construction for professional & intensive use in solar parks.



## ROTARY MOWERS - TOPPERS

### LB



- Sturdy rotary mower for pastures, parks and camp sites
- Profiled skids for excellent terrain adjustment
- Standard side shift (LB-245/275 with connecting rod)
- Widely overlapping blades

#### OPTIONS:

- Hydraulic offset
- Pulled front model
- Support saucer/rear roller for working on more uneven terrain
- Adjustable support wheels

TECHNICAL INFORMATION	LB-185	LB-245V	LB-275V	LB-360
Working width (cm/feet)	185 (6'11")	245 (8'1")	275 (9'0")	360 (11'10")
Speed:				
- PTO shaft (rpm)	540	540	540	540
- rotor spindles (rpm)	1685	1685	1685	1540
Required power, min. (kW/HP)*	18/25	26/35	29/40	33/45
Rotor spindles (number)	2	3	3	4
Total width (cm)	194	258	284	374
Cutting height (cm)	4-14	4-14	4-14	4-14
Tractor coupling system (cat.)	I + II	(I) + II	(I) + II	I + II
Weight (kg/lbs)	360 / 790	460 / 1015	510 / 1125	670 / 1475
Offset from tractor centre:				
- minimum (mid-mount)	93	122	138	183
- maximum manual (standard)	135	205	220	230
- maximum parallelogram (option)	135	200	218	224

\* Depending on the work to be carried out. A PTO shaft with an overload protection clutch must be used with oversized tractors. Mowing height from 4 to 14 cm.



## GEARBOX DRIVEN

### LK



- Mows high/dense grass, fallow land, natural terrain
- Rubber shock absorbers on the input and output gearbox shafts + PTO shaft with an overrun and overload protection clutch to safeguard the driveline

#### OPTIONS:

- Rear roller for optimal terrain adjustment
- Hydraulic offset
- Adjustable support wheels



TECHNICAL INFORMATION	LK-185	LK-215	LK-245	LK-275
Working width (cm/feet)	185 (6'1")	215 (7'1")	245 (8'1")	275 (9'0")
PTO power required power transmission at 540 rpm (kW/HP)	37/50	41/55	45/60	56/75
Number of rotors	2	2	3	3
Cutting height (cm)	4-14	4-14	4-14	4-14
Transport width (cm)	195	225	255	285
Maximum offset from tractor middle line (cm)	141	156	171	186
Weight (kg/lbs)	470 / 1035	490 / 1080	625 / 1375	700 / 1540



## OFFSET MOWING

# SV2-275



- Based on the LB-275
- Ultra-heavy-duty headstock for lasting stability
- PTO shaft with overrun clutch
- Articulation range +45 to -45 degrees
- Offset range 160 cm

### OPTIONS:

- Support saucer/rear roller for uneven terrain

TECHNICAL INFORMATION	SV2-275
Working width (cm/feet)	275 (9'0")
Speed:	
- PTO shaft (rpm)	540
- rotor (rpm)	1685
Required power, min. (kW/HP)*	29/40**
Rotor spindles (number)	3
Cutting height (cm)	4-14
Tractor coupling system (cat.)	II
Weight (kg/lbs)	675 / 1485
Offset from tractor centre	
- minimum (cm)	225
- maximum (cm)	385

\* Depending on the work to be carried out. A PTO shaft with an overload protection clutch must be used with oversized tractors.

\*\* For a minimal level of stability a tractor of min. 44 kW/60 hp is recommended.



## SOLAR PARK MOWER

# SUNSWING



- Very large offset
- Extra solid swing mechanism
- Strong v-belt drive with mostly automatic v-belt tensioners
- Full rubber front wheels
- Swing system with spring mechanism (adjustable resistance)
- Ejection protection to prevent damage from stones to solar panels (rubber edge around mower)

### OPTIES:

- Hydraulic adjustment of the swing arm position
- Raisable swing arm, mechanical/hydraulic (max 15 degrees)
- Hydraulic sensor (incl. volume controller, min. 20 l/min)

TECHNISCHE INFORMATIE	270	300	325	340	365
Cutting width (cm/feet)	270 (8'10")	300 (9'10")	325 (10'8")	340 (11'2")	365 (12'0")
Speed - PTO (rpm)	540	540	540	540	540
Req. min..Power (kW/pk)*	24/32	27/37	30/41	33/45	37/50
Number of blades	3+1	3+1	3+1	4+1	4+1
Diameter blade swing arm (cm)	60	60	85	60	85
Tractor coupling system (Cat.)	I + II	I + II	I + II	I + II	I + II
Weight (kg/lbs)	790 / 1740	900 / 1980	920 / 2025	1010 / 2225	1030 / 2265
Dimensions (see picture):					
- A minimum (cm)	110	140	155	185	200
- A maximum (cm)	230	255	280	300	325
- B (cm)	60	60	85	60	85
- C (mm)	295	295	295	295	295
- D (mm)	355	355	355	355	355

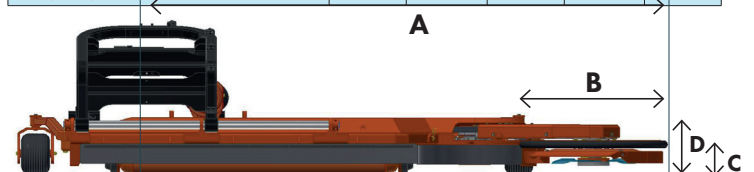



## SOLO-SWING MOWING DISCS

# PERFECT Solo-Swing

The hydraulic drive of our Solo-Swing mowing discs offers a broad range of mounting possibilities.



**Solo-Swing mowing discs are hydraulically driven and specifically designed for mowing around fence posts, trees and under solar panels, etc.**

- › Sturdy, compact construction
- › Height of disc/motor 23/32 cm (at a cutting height of 6 cm)
- › Heavy-duty swing-away blades
- › Various mounting possibilities
- › Easily adjustable resistance with springs
- › 30 l/min oil flow required
- › Articulation range and throw-out angle adjustable from 0 to 15 degrees
- › Standard bearing-mounted support saucer under cutter head



### Options:

- › Solo-Swing models can be fitted with a mechanical-hydraulic feeler for mowing around saplings/posts.



SZA-600



SZS-600

## SOLO-SWING ATTACHMENT MODEL

### SZA

- For mounting on rotary mower/flail mower
- Fast mounting and unmounting
- Working widths 50, 60 or 85 cm

#### OPTIONS:

- Hydraulic feeler bar for use in young trees or sloping terrain.
- Headstock for mini-loader



## 3-POINT REAR MOUNT

### SZS

- For tractor 3-point (rear mount) cat. I+II
- Quick and easy mounting and unmounting
- Working width 60 or 85 cm
- Linear hydraulic offset
- With tandem wheels for terrain adjustment

- Hydraulic feeler bar for use in young trees or sloping terrain.



TECHNICAL INFORMATION	SZA-500	SZA-600	SZA-850
Working width (cm/feet)	50 (1'8")	60 (2'0")	85 (2'9,5")
Required constant oil flow (l/min)	30	30	30
Required oil pressure (bar/psi)	± 65/940	±80/1160	±125/1810
Motor stroke (cc)	16	16	17,9
Articulation range/throw-out angle (°)	0-15	0-15	0-15
Required hydraulic connections on tractor	1x double acting + 1x free flow return	1x double acting + 1x free flow return	1x double acting + 1x free flow return
Weight (kg/lbs)	85 / 190	100 / 220	110 / 245

TECHNICAL INFORMATION	SZS-600	SZS-850
Working width (cm/feet)	60 (2'0")	85 (2'9,5")
Required constant oil delivery (l/min)	30	30
Required oil pressure (bar/psi)	±80	150
Motor stroke (cc)	16	17,9
Articulation range/throw-out angle (°)	0-15	0-15
Required hydraulic connections on tractor	2x double-acting valve + free flow return	2x double-acting valve + free flow return
Maximum offset from tractor centre (cm/feet)	210 (6'11")	225 (7'3")
Weight (kg/lbs)	175 / 385	195 / 480



SZX-850

## 3-POINT FRONT MOUNT

# SZX

- > Working width 60 cm / 85 cm
- > For tractor front lift
- > Parallelogram-type hydraulic offset system
- > With tandem wheels for terrain adjustment

### OPTIONS:

- > Rear version.
- > Hydraulic feeler bar for use in young trees or sloping terrain > 5%



TECHNICAL INFORMATION	SZX-600	SZX-850
Working width (cm/feet)	60 (2'0")	85 (2'9,5")
Required constant oil delivery (l/min)	30	30
Required oil pressure (bar/psi)	±80/1160	±150/2175
Motor stroke (cc)	16	17,9
Articulation range/throw-out angle (°)	0-15	0-15
Required hydraulic connections on tractor	2x double-acting valve + free flow return	2x double-acting valve + free flow return
Maximum offset from tractor centre (cm/feet)	235 (7'9")	245 (8'0")
Weight (kg/lbs)	255 / 560	275 / 605



## FLAIL MOWERS

# PERFECT Flail Mowers

PERFECT flail mowers are characterised by their high-quality construction and low maintenance requirements.

### The following features contribute to this:

- Ultra-sturdy construction
  - Flail shaft with maximum stability, balanced twice before and after the flail mounting
  - Optimal shredding of even the toughest vegetation with a minimal power requirement
  - Excellent terrain adjustment
  - Mown material is thrown out and spread over the rear roller
  - The roller bearings are fitted to the exterior for quick and easy maintenance.
- Covers limit the penetration of dirt and moisture, which significantly increases the lifespan of the bearings
  - Most models fitted with automatically tensioned V-belts as standard
  - Various flail options
  - Standard Walterscheid PTO shaft
  - Possibility to fit the flail rotor with Pro-Fix reinforcements for increased protections against stones and other objects

### FLAIL MOUNTING

PERFECT flails are attached to the electronically balanced flail shaft with heavy 20-mm bolts.

Replacing the flail ears always destabilises the flail shaft. PERFECT flail ears contain a replaceable hard steel tube, which means that they never have to be completely dismantled and replaced if the unit is used normally. This unique feature is an important factor in guaranteeing the long lifespan of PERFECT flail mowers and shredders (fitted on all units except for Flex-flails and Junior models).

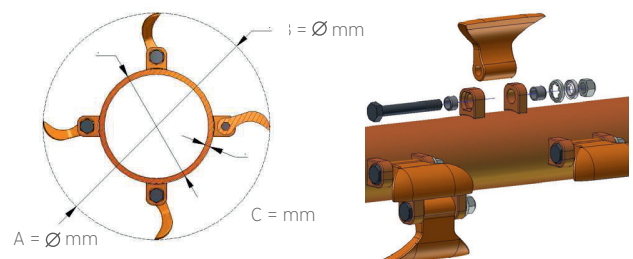

NEW!



BASIC FLAIL MOWER

# RABBIT



- 0,9 kg heavy flails, mounted on the valve shaft with heavy-duty 20 mm bolts and replaceable steel bushings
- Height-adjustable skids
- Height-adjustable roller
- Standard rubber protection
- For tractors up to 60 hp



Standard rubber protection

TECHNICAL INFORMATION	110	130	150	170	190
Working width (cm/feet)	110 (3'7")	130 (4'3")	150 (4'11")	170 (5'7")	190 (6'3")
Speed:					
- PTO shaft (rpm)	540	540	540	540	540
- flail shaft (rpm)	2300	2300	2300	2300	2300
Required power, min. (kW/HP)*	25/19	25/19	30/22	35/26	40/30
Flails 0.9 kg (number)	9	12	15	16	18
Total width (cm)	130	150	170	190	210
Weight (kg/lbs)	257/565	281/618	303/665	320/705	345/760



LIGHTER FLAIL MOWER

# KJ



- Light yet stable construction for use with smaller tractors
- For hobby farmers, parks, grassland, etc.
- Excellent terrain adjustment, rear roller located close to flail shaft, cleaned by flails
- Manoeuvrable, reliable and low-maintenance
- Fitted with 0.9 kg flails as standard
- For tractors up to 60 HP

OPTIONS:

- Hydraulic offset
- Front mount 1000 rpm

TECHNICAL INFORMATION	KJ-120	KJ-150	KJ-180	KJ-210
Working width (cm/feet)	120 (3'11")	150 (4'11")	180 (5'11")	210 (6'11")
Speed:				
- PTO shaft (rpm)	540	540	540	540
- flail shaft (rpm)	2100	2100	2100	2100
Required power, min. (kW/HP)*	20	23	27	32
Flails 0.9 kg (number)	14	16	18	22
Total width (cm)	136	166	196	226
Tractor coupling system (cat.)	I + II	I + II	I + II	I + II
Weight (kg/lbs)	305 / 670	335 / 740	360 / 790	405 / 890
Offset from tractor centre line:				
• fixed 3-point attachment plate (standard) cm	68	78	108	138
• hydraulic offset (optional)				
- minimum (cm)	40	53	83	113
- maximum (cm)	91	104	134	164

\* Depending on the work to be carried out. A PTO shaft with an overload protection clutch must be used with oversized tractors.



## HYDRAULIC FLAIL MOWER

### KJ-HYDRO



- Flail mower specially designed for hydraulic drive
- 0,9 kg flails, mounted on an electric balanced flail rotor
- Grass discharge over the rear roller
- Skids and rear roller

#### OPTIONS:

- Front wheel set
- Hydraulic offset
- Headstock (A or B)



Type A: Headstock



Type B: Headstock (trailed)

TECHNICAL INFORMATION	KJ-120	KJ-150	KJ-180
Working width (cm/feet)	120 (3'11")	150 (4'11")	180 (5'11")
Hydro motor (l/min)	35	35	55
Flailshaft (rpm)	2100	2100	2100
Number of Flails 0.9 kg	14	16	18
Total width (cm)	136	166	196
Weight (kg/lbs)	305 / 670	335 / 740	360 / 790
Hydraulic offset (option):			
- minimum (cm)	40	53	83
- maximum (cm)	91	104	134



## COMPACT FLAIL MOWER

### KP



- Compact, sturdy construction
- For pastures, parks, etc.
- Excellent terrain adjustment, rear roller located close to flail shaft
- Manoeuvrable, reliable and low-maintenance
- Flails attached with 20 mm bolts and replaceable bushings
- Rear roller bearings with covers
- For tractors over 25 HP

#### OPTIONS:

- Front mount 540 or 1000 rpm, including gearbox with integrated overrun clutch
- Hydraulic offset
- Various flail options (see page 21)

TECHNICAL INFORMATION	KP-150	KP-180	KP-210	KP-240
Working width (cm/feet)	150 (4'11")	180 (5'11")	210 (6'11")	240 (7'11")
Speed:				
- PTO shaft (rpm)	540	540	540	540
- flail shaft (rpm)	2100	2100	2100	2100
Required power, min. (kW/HP)*	18/25	21/28	25/34	30/41
Flails 0.9 kg (number)	16	18	22	24
Total width (cm)	172	202	232	262
Tractor coupling system (cat.)	I + II	I + II	I + II	I + II
Weight (kg/lbs)	425 / 940	465 / 1025	530 / 1170	605 / 1335
Offset from tractor centre line:				
• fixed 3-point attachment plate (standard) cm	80	110	140	154
• hydraulic offset (optional)				
- minimum (cm)	55	85	115	130
- maximum (cm)	105	135	165	180



## ALL ROUND FLAIL MOWER

### KW



- Ideal for topping road side verges, fallow land with light vegetation, green manure crops, etc.
- Solid construction, large flail shaft/rear roller
- Mechanical offset 48 cm
- Gearbox (540 t/min) with integrated overrun clutch
- Automatic V-belt tensioning
- Excellent price/quality ratio

#### OPTIONS:

- Hydraulic offset
- Pro-Fix
- Wear plate
- Rubber flap (rear)
- Various flail options (see page 21)

TECHNICAL INFORMATION	KW-245	KW-270	KW-300
Working width (cm/feet)	245 (8'1")	270 (8'10")	300 (9'10")
Speed:			
- PTO shaft (rpm)	540	540	540
- flail shaft (rpm)	1890	1890	1890
Minimum tractor power (kW/HP)*	33/45	40/55	48/65
Flails 0.9 kg (number)	24	28	32
Total width (cm)	261	286	316
Tractor coupling system (cat.)	II	II	II
Weight (kg/lbs)	830 / 1830	875 / 1930	920 / 2030
Offset from tractor centre line:			
- minimum (cm)	88	113	143
- maximum (cm)	135	160	190

\* Depending on the work to be carried out. A PTO shaft with an overload protection clutch must be used with oversized tractors.



## ALL ROUND FRONT/REAR FLAIL MOWER

### KR



- Solid construction, large flail shaft/rear roller
- Standard hydraulic offset 48 cm
- 1000 rpm gearbox with double overrunning clutch that accepts both RH and LH rotation
- Automatic V-belt tensioning
- Excellent price/quality ratio

#### OPTIONS:

- Wear plate
- Pro-Fix
- Rubber flap (rear)
- Various flail options (see page 21)

TECHNICAL INFORMATION	KR-245	KR-270	KR-300
Working width (cm/feet)	245 (8'1")	270 (8'10")	300 (9'10")
Speed:			
- PTO shaft (rpm)	1000	1000	1000
- flail shaft (rpm)	1890	1890	1890
Minimum tractor power (kW/HP)*	33/45	40/55	48/65
Flails 0.9 kg (number)	24	28	32
Total width (cm)	261	286	316
Tractor coupling system (cat.)	II	II	II
Weight (kg/lbs)	930 / 2045	975 / 2145	1020 / 2245
Offset from tractor centre line:			
- minimum (cm)	88	113	143
- maximum (cm)	135	160	190



## HEAVY DUTY FLAIL MOWER WITH ADJUSTABLE HOOD

### KT



- Ultra-heavy-duty construction, large flail shaft/rear roller
- Super spacious frame with adjustable rear cover
- For mowing fallow land, green manure crops, corn stalks stubble, etc.
- 1000 rpm drive

#### OPTIONS:

- Various flail options (see page 20) e.g. 2.2 kg HD or 2.7 kg Combi-flails
- Mechanical/hydraulic offset
- Wear plate
- Large rubber swivelling wheels instead of rear roller
- Front headstock
- 3D-Flex headstock; hydraulic 3D-levelling, super-offset (1100 mm) left and right, best possible ground contour following

TECHNICAL INFORMATION	KT-245	KT-270	KT-300	KT2-320
Working width (cm/feet)	245 (8'1")	270 (8'10")	300 (9'10")	320 (10'6")
Speed:				
- PTO shaft (rpm)	1000	1000	1000	1000
- flail shaft (rpm)	2100	2100	2100	1750
Required power, min. (kW/HP)*	40/55	48/65	55/75	62/85
Flails standard 0.9 kg (2.2 kg)	24 (16)	28 (16)	32 (18)	32 (20)
Transport width (cm)	274	299	329	349
Tractor coupling system (cat.)	II	II	II	II
Weight (kg/lbs)	900 / 1985	970 / 2140	1030 / 2270	1320 / 2975
Offset from tractor middle line:				
• fixed 3-point attachment plate (standard) cm	143	168	150	160
• hydraulic offset (optional)				
- minimum (cm)	115	140	122	132
- maximum (cm)	172	197	180	190



## HEAVY DUTY FRONT/REAR FLAIL MOWER

### KM



- Ultra-heavy-duty construction, large flail shaft/rear roller
- Standard hydraulic offset 57 cm
- 1000 rpm gearbox with overrun clutch that accepts both RH and LH rotation
- Ultra-strong headstock with replaceable slide plates

#### OPTIONS:

- Wear plate
- Pro-Fix
- Lighting & marking signs
- Various flail options (see page 21)

TECHNICAL INFORMATION	KM-220	KM-245	KM-270	KM-300
Working width (cm/feet)	220 (7'3")	245 (8'1")	270 (8'10")	300 (9'10")
Speed:				
- PTO shaft (rpm)	1000	1000	1000	1000
- flail shaft (rpm)	2200	2200	2200	2200
Required power, min. (kW/HP)*	35/48	40/55	48/65	55/75
Flails standard 0.9 kg (2.2 kg)	24 (16)	24 (16)	28 (16)	32 (18)
Transport width (cm)	247	272	297	327
Tractor coupling system (cat.)	II	II	II	II
Weight (kg/lbs)	1000 / 2205	1030 / 2270	1120 / 2470	1200 / 2645
Hydraulic offset from tractor middle line:				
- minimum (cm)	91	116	141	123
- maximum (cm)	148	173	198	180



**NEW!**



## MULTIPURPOSE MULTI-MOWER

# GREENFLEX



- 0.9 kg heavy flails, mounted on the flail shaft with heavy 20 mm bolts and interchangeable steel bushings.
- Gearbox on the inside
- Grass discharge over the roller
- Large hydraulic offset possibility
- Height-adjustable skids



Side-view of Greenflex

TECHNISCHE INFORMATIE	150	170	190	210	230
Working width (cm/feet) (A)	150 (4'11")	170 (5'7")	190 (6'3")	210 (6'11")	230 (7'11")
Speed:					
- PTO shaft (rpm)	540	540	540	540	540
- flail shaft (rpm)	2300	2300	2300	2300	2300
Required power, min. (kW/HP)*	37/50**	37/50**	44/60**	44/60**	44/60**
Flails 0.9 kg (number)	15	16	18	21	24
Transport width (cm)	173	193	213	233	253
Tractor coupling system (cat.)	II	II	II	II	II
Weight (kg/lbs)	556 / 1123	568 / 1250	585 / 1287	606 / 1333	627 / 1380
Offset from tractor middle line:					
- minimum (cm)	113	133	153	173	193
- maximum (cm)	238	258	278	298	318

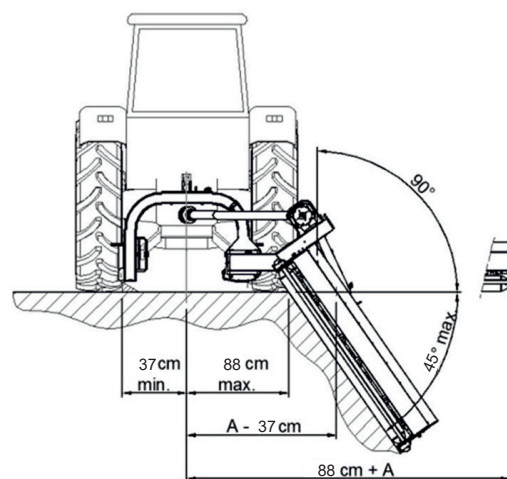

\* Depending on the work to be carried out. A PTO shaft with an overload protection clutch must be used with oversized tractors.

\*\* For a minimal level of stability a tractor of min. 44 kW/60 hp is recommended



## STURDY MULTIMOWER

# ZW PLUS



### PLUS:

- Internal roller bearing
- Heavy-duty top bracket for long-term stability
- Robust construction, double-walled frame where required, extra-heavy-duty bearing on the folding shaft
- Versatile all round mower for field edges, pastures, road-side verges, sides of ditches, etc.
- Sturdy construction, double-skin frame in all the necessary places
- Internally reinforced headstock and arms for lasting stability
- Extreme offset/mowing range by locating the gearbox on the frame exterior
- Walterscheid PTO shaft with overrun clutch and star profile
- Collision protection: Spring system in offset arms

### OPTIONS:

- Front-mount 1000 rpm
- Left hand version
- Pro-Fix
- Various flail options (see page 21)

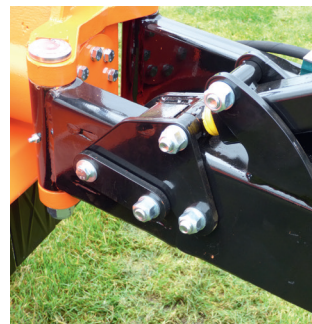

Collision protection in offset arms



Heavy 3-point linkage

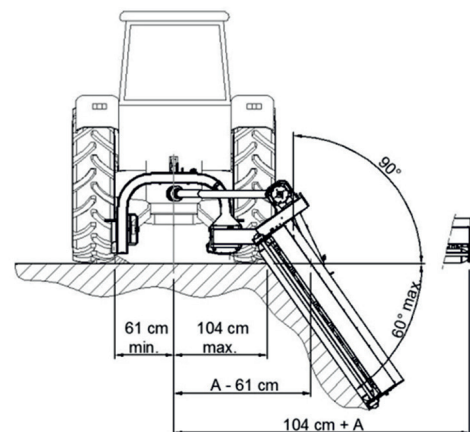

TECHNICAL INFORMATION	ZW-150 PLUS	ZW-180 PLUS	ZW-210 PLUS	ZW-240 PLUS
Working width (cm/feet) (A)	150 (4'11")	180 (5'11")	210 (6'11")	240 (7'11")
Speed:				
- PTO shaft (rpm)	540	540	540	540
- flail shaft (rpm)	2075	2075	2075	2010
Required power, min. (kW/HP)*	37/50**	44/60**	51/70**	59/80**
Flails 0.9 kg (number)	16	18	22	24
Transport width (cm)	140	140	140	140
Tractor coupling system (cat.)	II	II	II	II
Weight (kg/lbs)	735 / 1620	780 / 1720	840 / 1852	900 / 1980
Offset from tractor middle line:				
- minimum (cm)	90	120	150	180
- maximum (cm)	255	285	315	345
Offset from tractor middle line (front-mount models)				
- minimum (cm)	115	145	175	205
- maximum (cm)	225	255	285	315

\* Depending on the work to be carried out. A PTO shaft with an overload protection clutch must be used with oversized tractors.

\*\* For a minimal level of stability a tractor of min. 44 kW/60 hp is recommended

**NEW!**



## PROFESSIONAL SIDE FLAIL MOWER

# ZF PRO



- For professional/intensive use on roadside verges, field edges, mowing green manure crops or maize stubble, etc.
- Extremely strong; double-skin frame in all the necessary places
- Driven through a 5 fold Powerbelt and reinforced gearbox
- A flexible rubber coupling between the gearbox and flail shaft eliminates peak strokes on the drive system
- 1000 rpm drive
- Unique, extremely reliable collision protection integrated in main frame
- 0,9 kg or 2,2 kg flails

### OPTIONS:

- Hydro-lift for mowing shallow ditches with a large mowing head
- Front-mounted model and/or left hand side model
- Pro-Fix
- Various flail options (see page 21)

TECHNICAL INFORMATION	ZF-150 PRO	ZF-180 PRO	ZF-210 PRO	ZF-240 PRO
Working width (cm/feet) (A)	150 (4'11")	180 (5'11")	210 (6'11")	240 (7'11")
Speed:				
- PTO shaft (rpm)	1000	1000	1000	1000
- flail shaft (rpm)	2230	2230	2230	2230
Required power, min. (kW/HP)*	44/60*	50/68*	55/75*	65/88**
Flails standard 0.9 kg (2.2 kg)	16 (9)	18 (12)	22 (12)	24 (16)
Transport width (cm)	187	187	187	187
Tractor coupling system (cat.)	II	II	II	II
Weight (kg/lbs)	900 / 1960	950 / 2070	1000 / 2180	1080 / 2310
Offset from tractor middle line				
- minimum (cm)	255	285	315	345
- maximum (cm)	325	355	385	415

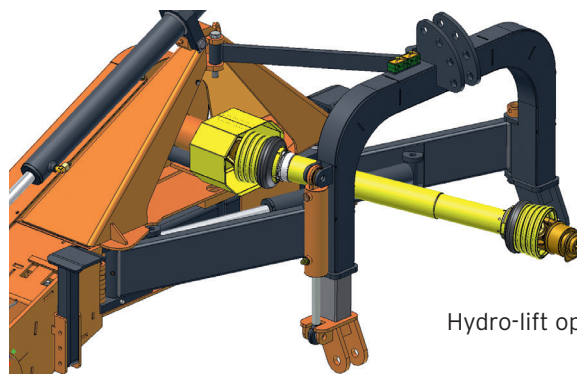

Hydro-lift option

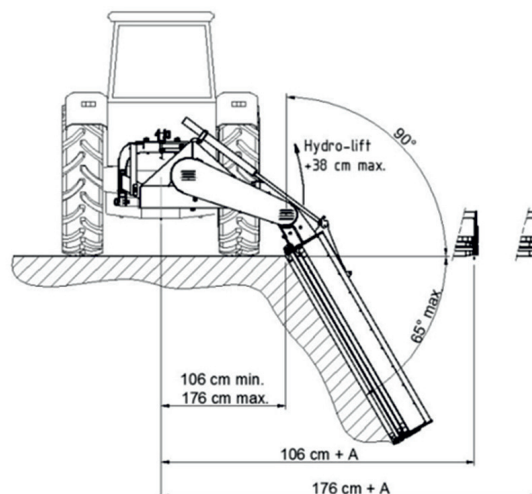

\* Depending on the work to be carried out. A PTO shaft with an overload protection clutch must be used with oversized tractors.

\*\* For a minimal level of stability a tractor of min. 58 kW / 80 hp (\*\*69 kW/100 hp is recommended).



## DUAL MOWER WITH MAXIMUM CAPACITY ON WHEEL SET

### RX-620



- For mowing green manure crops, fallow land, corn stalks, airfields, etc.
- Two heavy-duty flail mowers with wide overlap
- Fitted with 2.2 kg heavy-duty flails as standard
- Flail shaft diameter 273 mm
- Heavy, trailed frame, mowers with swinging suspension
- Ground pressure relief adjustable with heavy coiled springs
- 1000 rpm drive
- Adjustable rear hoods
- Suitable for tractors over 150 HP/113 kW

#### OPTIONS:

- Continuously variable adjustment of cutting height
- Hydraulic/pneumatic brake system
- Wear plates
- Pro-Fix
- Various flail options (see page 21)



#### TECHNICAL INFORMATION

#### RX-620

Working width (cm/feet)	620 (20'4")
Speed:	
- PTO shaft (rpm)	1000
- flail shaft (rpm)	1800
Required power (kW/HP)	113/150
Flails standard 2.2 kg/flail	40
V-belts	2 x 5 Red Power
Required hydraulic connections	2 x EW
Wheels	15.0 / 55-R17
Coupling system (cat.)	III
Weight (kg/lbs)	3500 / 3700
Transport	
- height (cm)	390
- width (cm)	220



## HEAVY DUTY TRIPLE FLAIL MOWER

# TRIWING



- > Heavy carrying frame with two 3.20 m side mowers
- > Centre mower for front mounting or connecting behind the side mowers
- > Drive 1000 rpm
- > Direct drive system for the side mowers
- > Diameter of flail shafts 273 mm (central mower 219 mm)
- > "Trailed" front mower
- > Fitted with 2.2 kg heavy-duty flails as standard
- > Various attachment possibilities (including, for example, reverse drive)
- > Hydropneumatic ground pressure relief

### OPTIONS:

- > Central lubrication system
- > Chain protection instead of clacks
- > Electronically controlled hydraulic system operation, including ground-pressure relief
- > 3.0 mtr front mower instead of 2.7 mtr
- > Wear plates
- > Pro-Fix
- > Various flail options (see page 21)



### TECHNICAL INFORMATION

### TRIWING

Working width (cm/feet)	860 (28'0")
Speed:	
- PTO shaft (rpm)	1000
Required power (kW/HP)*	185/250
Transport width (cm)	296
Flails standard 2.2 kg/flail	56
Tractor coupling system (cat.)	III/IV
Required hydraulic connections	2 x EW
Weight (kg/lbs)	5000 / 11000
Transport height (cm)	390



FLAIL MOWERS

# PERFECT Flail Options

PERFECT flails are cast from a special steel and boron alloy, which makes that the cutting edge hardens when it gets in contact with the shredding material. The result is a great performance and a long life.

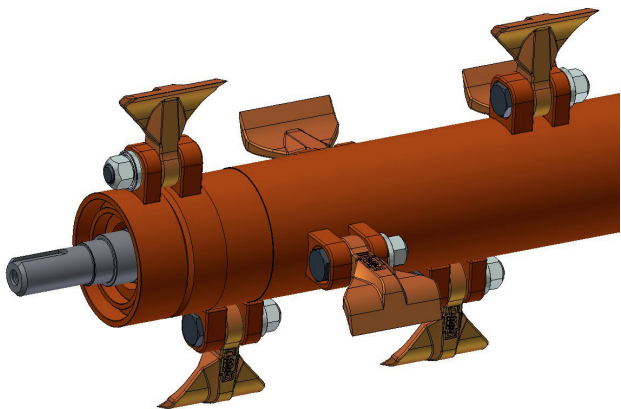

**0,9 KG:**

Straight, continuous cutting edge that guarantees a uniform cutting height. Ideal for grass, green manure crops and other light crop stubble.

Available on models:

- RABBIT
- KJ (Hydro)
- KP
- KR
- KW
- KT
- KM
- RX
- GREENFLEX
- ZW PLUS
- ZF PRO
- TRIWING

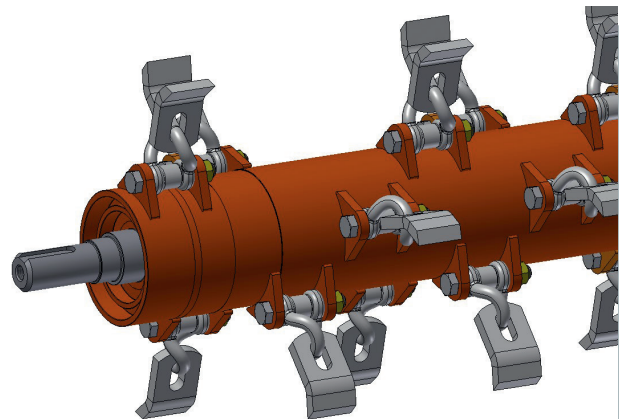

**FLEX-FLAILS:**

Flexible suspension, specially designed for terrain with a lot of (large) stones.

Available on models:

- KP
- KW
- KR
- ZW PLUS
- ZF PRO



FLAIL MOWERS

# PERFECT Flail Options

PERFECT flails are cast from a special steel and boron alloy, which makes that the cutting edge hardens when it gets in contact with the shredding material. The result is a great performance and a long life.

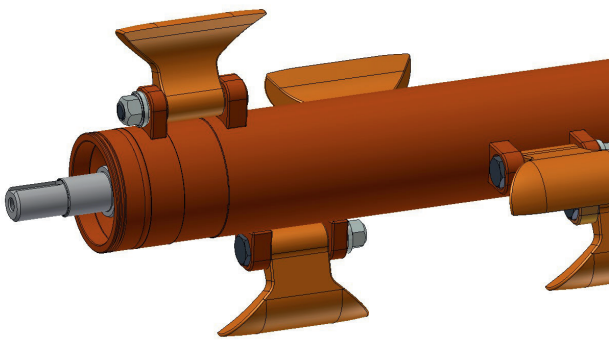

**2,2 KG:**

Universal heavy flail, less chance of damage, for corn stalks or use in extremely heavy conditions.

Available on models:

- KT
- KM
- RX
- TRIWING
- ZF PRO

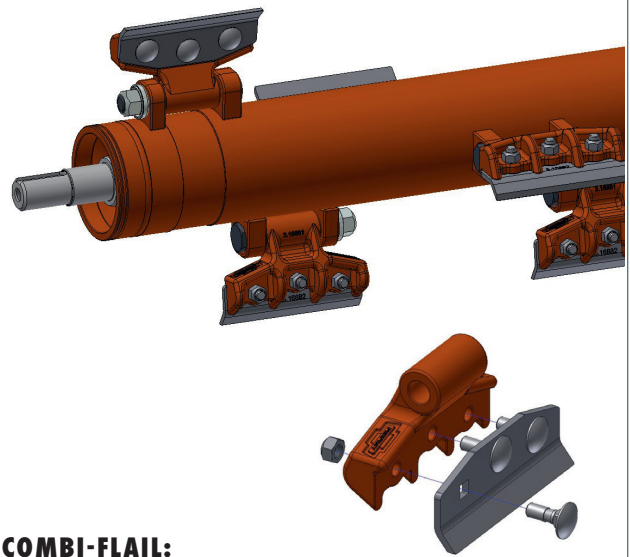

**COMBI-FLAIL:**

Large impact force (2.7 kg) combined with a replaceable and permanently sharp cutting edge. Optimal mowing height for all crops or on all terrains.

Available on models:

- KT
- KM
- RX
- TRIWING
- ZF PRO

## Pro-Fix (option)

For maximum protection of the flail shaft in very heavy circumstances, the Pro-Fix flail mounting is a of great added value. If the machine comes into contact with a large stone, tree stump or other large and hard object, this hardened steel guide ensures that the flail mounting ear is not damaged.

Available on all models except RABBIT, KJ (Hydro) & GREENFLEX  
Not in combination with Flex-Flails.





SERIES	KJ (-HYDRO)				KP				KW			
MODELS	KJ-120	KJ-150	KJ-180	KJ-210	KP-150	KP-180	KP-210	KP240	KW-245	KW-270	KW-300	
Working width (cm)	120	150	180	210	150	180	210	240	245	270	300	
Usage capacity												
Headstock standard (options)	3-point rear (front) Not with Hydro				3-point rear (front)				3-point rear			
Tractor coupling system (cat.)	I/II (not with Hydro)				I/II				II			
<b>SPEED (RPM)</b>												
PTO shaft	540/ 33 l/min	540/ 33 l/min	540/ 33 l/min	540 -	540	540	540	540	540	540	540	
KJ-Hydro motor												
Flail shaft	2100	2100	2100	2100	2100	2100	2100	2100	1890	1890	1890	
<b>FLAIL SHAFT</b>												
Diameter A (mm)	140	140	140	140	140	140	140	160	219	219	219	
Diameter B (mm)	407	407	407	407	407	407	407	427	485	485	485	
Wall strength C (mm)	10	10	10	10	12,5	12,5	12,5	12,5	10	10	10	
Number of V-belts	3	3	3	3	3	3	3	3	4	4	4	
V-belt tensioning	bolt	bolt	bolt	bolt	bolt	bolt	bolt	bolt	automatic	automatic	automatic	
Minimum tractor power (kW/HP)	15/20	20/27	28/32	25/34	18/25	21/28	25/34	45/33	33/45	40/55	48/65	
<b>FLAILS (NUMBER)</b>												
0.9 kg (standard)	14	16	18	22	16	18	22	24	24	28	32	
Flex-flails (option)	-	-	-	-	32	40	48	54	55	61	68	
Transport width (cm)	140	170	200	230	170	200	230	260	261	286	316	
<b>OFFSET FROM TRACTOR MIDDLE LINE</b>												
Minimum (cm)	40	53	83	113	55	85	115	130	88	113	143	
Maximum (cm)	91	104	134	164	105	135	165	180	135	160	190	
Cutting height (cm)	1,0 - 7,5				0 - 11,5				3 - 13			
Weight (kg)	305	325	350	390	425	465	530	605	830	875	920	



SERIES	KR			KT				KM			
MODELS	KR-245	KR-270	KR-300	KT-245	KT-270	KT-300	KT-320	KM-220	KM-245	KM-270	KM-300
Working width (cm)	245	270	300	245	270	300	320	220	245	270	300
Usage capacity											
Headstock standard (options)	3-point front and rear			3-point rear (front)				3-point front and rear			
Tractor coupling system (cat.)	II			II				II			
<b>SPEED (RPM)</b>											
PTO shaft	1000	1000	1000	1000	1000	1000	1000	1000	1000	1000	1000
Flail shaft	1890	1890	1890	2100	2100	2100	1750	1850	1850	1850	1850
<b>FLAIL SHAFT</b>											
Diameter A (mm)	219	219	219	219	219	219	273	178	219	219	219
Diameter B (mm)	485	485	485	485	485	485	540	445	485	485	485
Wall strength C (mm)	10	10	10	12,5	12,5	12,5	12,5	14,2	10	10	10
Number of V-belts	4	4	4	4	4	4	5	4	4	4	4
V-belt tensioning	automatic	automatic	automatic	automatic	automatic	automatic	automatic	automatic	automatic	automatic	automatic
Minimum tractor power (kW/HP)	33/45	40/55	48/65	40/55	48/65	55/75	62/85	35/48	40/55	48/65	55/75
<b>FLAILS (NUMBER)</b>											
0.9 kg (standard)	24	28	32	24	28	32	32	22	24	28	32
Flex-flails (option)	55	61	68	-	-	-	-	-	-	-	-
2.2 kg (option)	-	-	-	16	16	18	20	12	16	16	18
Combi-flail (option)	-	-	-	16	16	18	20	12	12	16	18
Transport width (cm)	261	286	316	275	299	329	349	247	272	297	327
<b>OFFSET FROM TRACTOR MIDDLE LINE</b>											
Fixed headstock (fitted as standard on KT models)	-	-	-	143	168	150	160	-	-	-	-
Minimum (cm)	88	113	143	115	140	122	132	91	116	141	123
Maximum (cm)	135	160	190	172	197	180	190	148	173	198	180
Cutting height (cm)	3 - 13			2 - 11				2 - 11			
Weight (kg)	930	975	1020	900	970	1030	1095	1000	1030	1120	1200



SERIES	ZW PLUS				ZF PRO			
MODELS	ZW-150 PLUS	ZW-180 PLUS	ZW-210 PLUS	ZW-240 PLUS	ZF-150 PRO	ZF-180 PRO	ZF-210 PRO	ZF-240 PRO
Working width (cm)	150	180	210	240	150	180	210	240
Usage capacity								
Headstock standard (options)	3-point rear (front)				3-point rear (front)			
Tractor coupling system (cat.)	II	II	II	II	II	II	II	II
<b>SPEED (RPM)</b>								
PTO shaft	540	540	540	540	1000	1000	1000	1000
Flail shaft	2075	2075	2075	2010	2230	2230	2230	2230
<b>FLAIL SHAFT</b>								
Diameter A (mm)	140	140	140	160	140	140	140	160
Diameter B (mm)	407	407	407	427	407	407	407	427
Wall strength C (mm)	12,5	12,5	12,5	12,5	12,5	12,5	12,5	12,5
Number of V-belts	3	3	3	4	Powerband (five-fold)			
V-belt tensioner	bolt	bolt	bolt	bolt	automatic	automatic	automatic	automatic
Minimum tractor power (kW/HP)	37/50	44/60	51/70	59/80	44/60	50/68	55/75	65/88
<b>FLAILS (NUMBER)</b>								
0.9 kg (standard)	16	18	22	24	16	18	22	24
Flex-flails (option)	32	40	48	54	-	-	-	-
2.2 kg (option)	-	-	-	-	9	12	12	16
Combi-flail (option)	-	-	-	-	9	12	12	16
Transport width (cm)	140	140	140	140	187	187	187	187
<b>OFFSET FROM TRACTOR MIDDLE LINE</b>								
Minimum (cm)	90	120	150	180	255	285	315	345
Maximum (cm)	255	285	315	345	325	355	385	415
Articulation range °	+90° to -60°				+90° to -65°			
Cutting height (cm)	1 - 12				2 - 9			
Weight (kg)	735	780	840	900	900	950	1020	1080

SERIES	RX	TRIWING		RABBIT				
MODELS	RX-620	SIDE MOWERS	CENTRAL MOWER	RABBIT-110	RABBIT-130	RABBIT-150	RABBIT-170	RABBIT-190
Total working width (cm)	620	860		110	130	150	170	190
Working width per unit (cm)	2 x 320	2 x 320	1 x 270	110	130	150	170	190
Usage capacity								
Headstock standard (options)	3-point rear (pulled)	3-point rear (+ front)		3-point rear				
Tractor coupling system (cat.)	III	III	III	I/II				
<b>SPEED (RPM)</b>								
PTO shaft	1000	1000	1000	540				
Flail shaft	1750	1750	1850	2300				
<b>FLAIL SHAFT</b>								
Diameter A (mm)	273	273	219	159				
Diameter B (mm)	540	540	485	425				
Wall-thickness C (mm)	12,5	12,5	10	8				
Number of V-belts	5	5	4	3				
V-belt tensioning	automatic	automatic	automatic	bolt	bolt	bolt	bolt	bolt
Minimum tractor power (kW/HP)	110/150	185/250		25/19	25/19	30/22	35/26	40/30
<b>FLAILS (NUMBER)</b>								
2.2 kg (standard)	20	20	16	-	-	-	-	-
Combi-flail (option)	20	20	16	-	-	-	-	-
0.9 kg (option)	32	32	28	9	12	15	16	18
Transport width (cm)	248	296		3 - 9				
Cutting height (cm) (3 point)	2 - 11	2 - 11		114				
Weight (kg)	3500	4800		260	280	300	320	345



SERIES	GREENFLEX				
MODELS	GREENFLEX-150	GREENFLEX-170	GREENFLEX-190	GREENFLEX-210	GREENFLEX-230
Working width (cm)	150	170	190	210	230
Usage capacity					
Headstock standard (options)	 3-point rear				
Tractor coupling system (cat.)	II				
SPEED (RPM)					
PTO shaft	540				
Flail shaft	2300				
FLAIL SHAFT					
Diameter A (mm)	159				
Diameter B (mm)	425				
Wall strength C (mm)	8				
Number of V-belts	3		4		
V-belt tensioner	bolt	bolt	bolt	bolt	bolt
Minimum tractor power (kW/HP)	37/50		51/70		
FLAILS (NUMBER)					
0,9 kg (option)	15	16	18	21	24
Transport width (cm)	173	193	213	233	253
Diameter roller (mm)	133				
OFFSET FROM TRACTOR MIDDLE LINE					
Minimum (cm)	113	133	153	173	193
Maximum (cm)	238	258	278	298	318
Articulation range °	+ 90 to -45				
Cutting height (cm)	3 - 9				
Weight (kg)	545	570	585	610	630

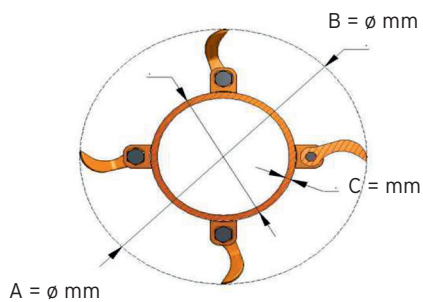

## NOTES

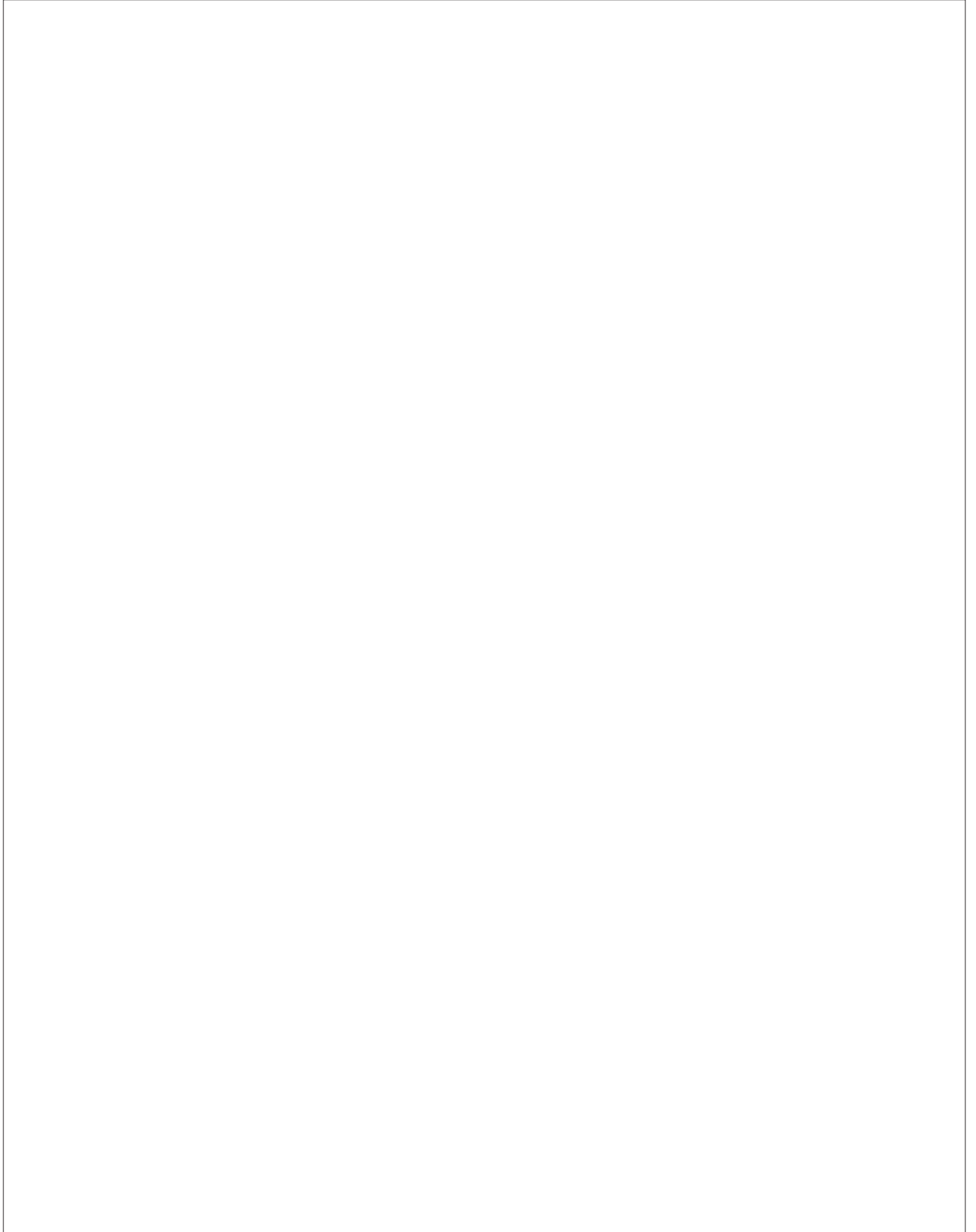

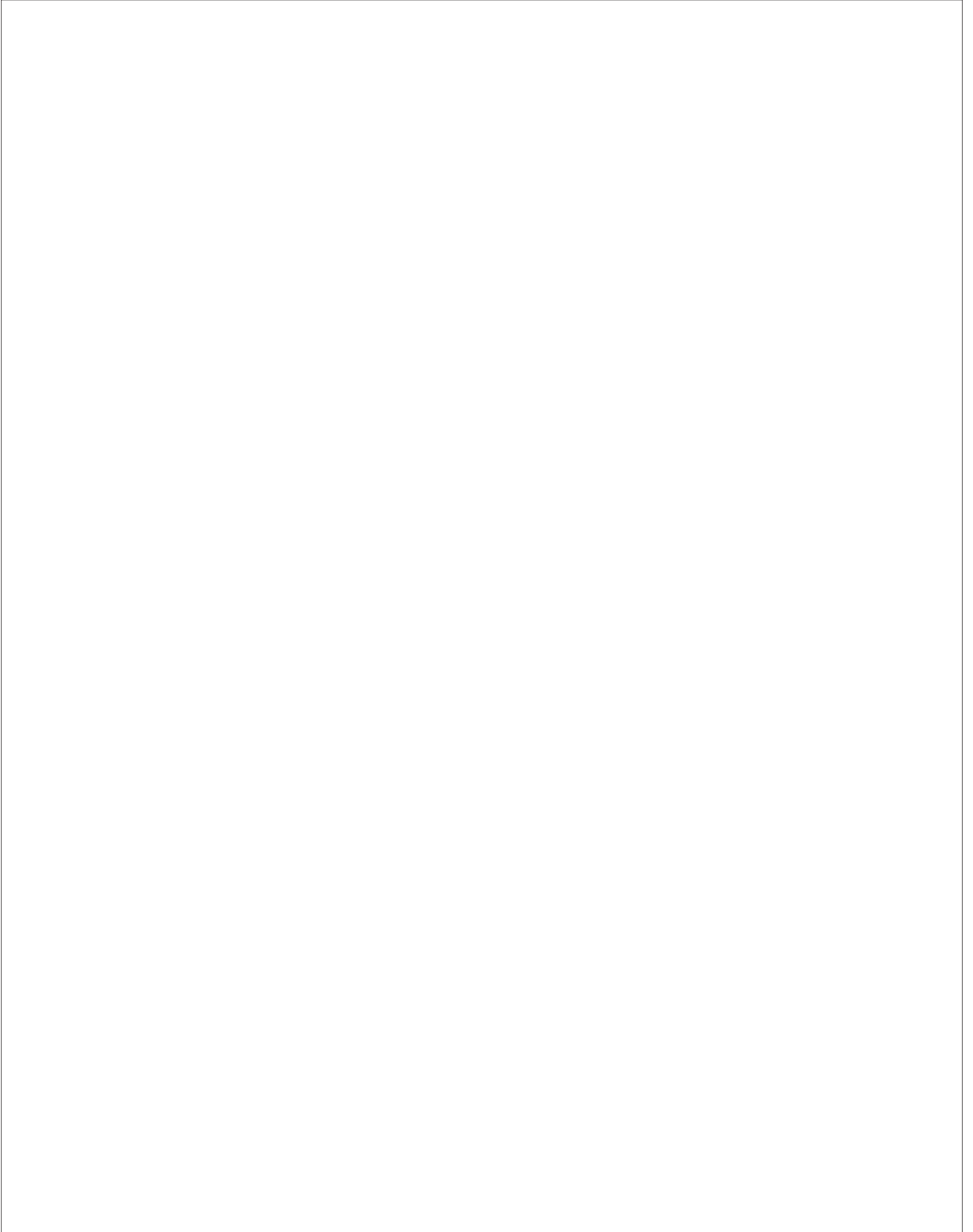



📍 **PERFECT Van Wamel B.V.**  
Energieweg 1, 6658 AE  
Beneden Leeuwen  
The Netherlands

☎ +31 (0) 487 59 29 44  
@ [www.perfectvanwamel.com](http://www.perfectvanwamel.com)  
🌐 [sales@vanwamel.nl](mailto:sales@vanwamel.nl)

**Your PERFECT partner**